

REV.	ECN.NO.	MODIFY.CONTENT	DATE
A		NEW	2011/10/31

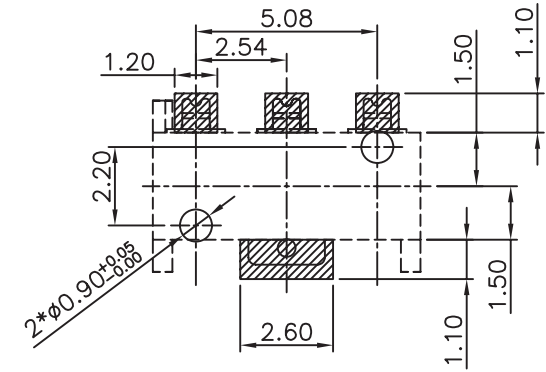

RECOMMENDED PADS LAYOUT
TOP VIEW
TOLERANCE : ±0.05

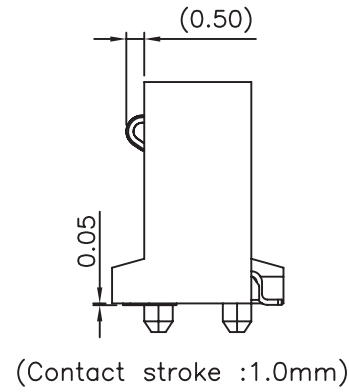
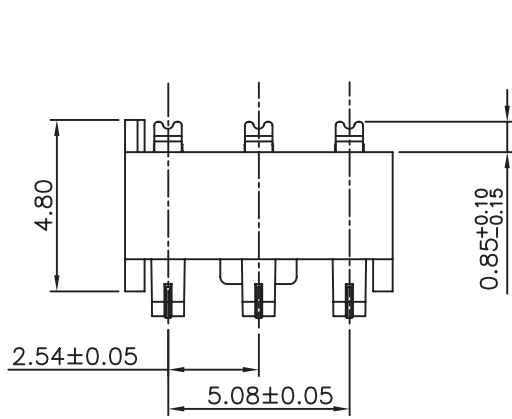
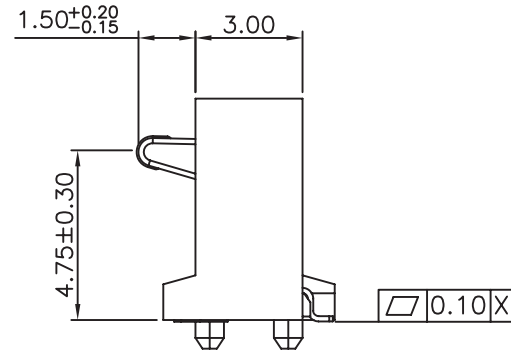
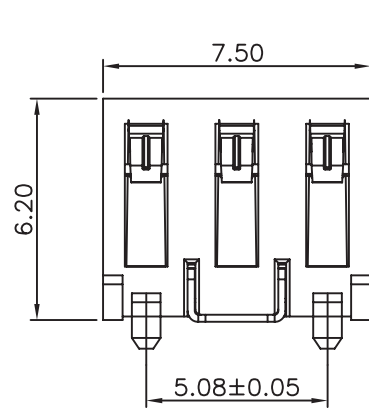

NOTES:

- HOUSING MATERIAL:LCP BLACK UL 94V-0
- CONTACT MATERIAL:COPPER ALLOY.
FINISH:NICKEL UNDERPLATED, GOLD PLATING ON CONTACT AREA, TIN PLATING ON SOLDER AREA
- NAIL MATERIAL:COPPER ALLOY.
FINISH:NICKEL UNDERPLATED, PLATED TIN OVER ALL.

PART NUMBER INFORMATION :

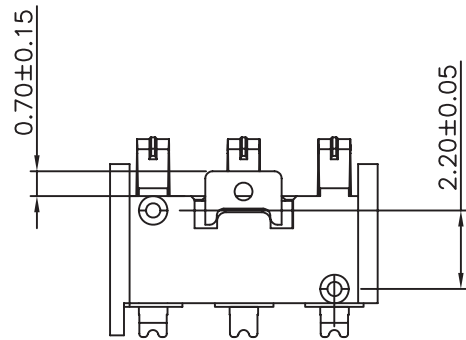
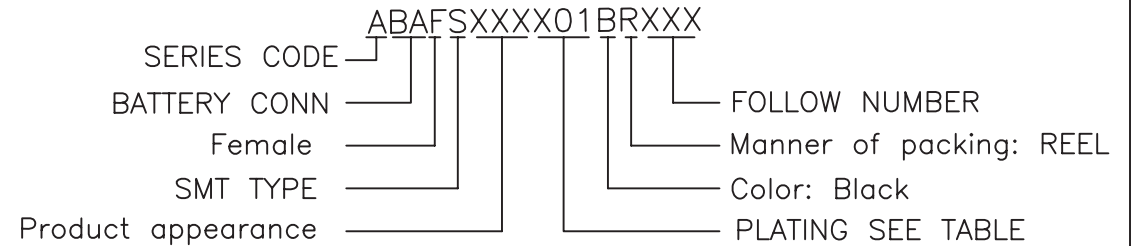

GENERAL TOLERANCE		DWG NO.	LZA0519-001	APPD:	WIND	Scale	1:1
X.±0.45	x.±5°	Title	BATTERY 3PIN 2.54.0PITCH 6.2H	CHKD:		UNIT	mm
.X±0.35	.x'±2°			DR:			
.XX±0.25	.xx'±1°	Part NO.	ABAFS062B01BR020	Date	2012/02/29		
.XXX±0.15	.xxx'±0.5°						
SHEET	1/1			东莞市汉硕电子科技有限公司			

REV.	ECN.NO.	MODIFY.CONTENT	DATE
A		NEW	2012/04/13

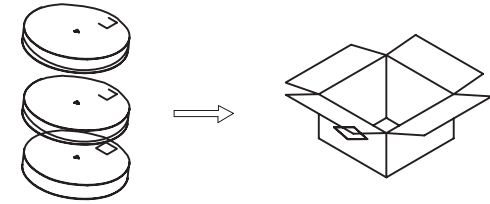
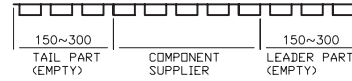
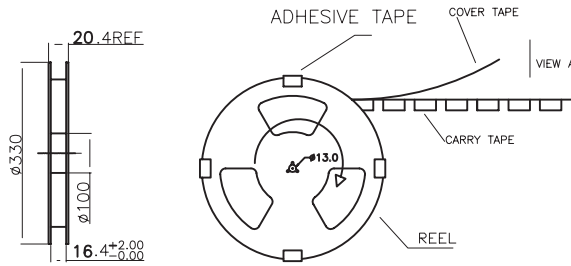

每箱装17盘, 依次叠在一起(图一)

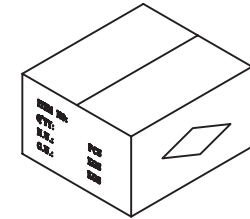

封箱, 填写相关内容(图二)

对应三视图

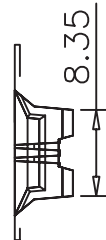
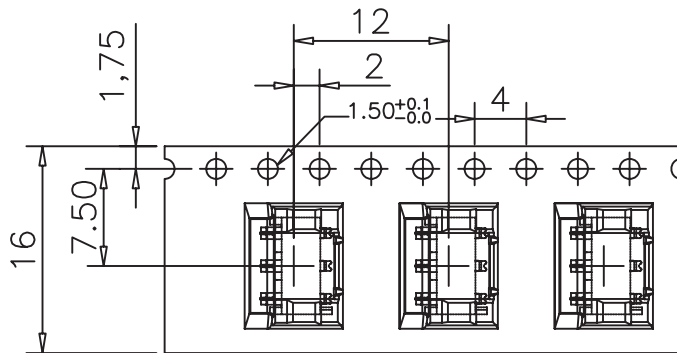

NOTE:

1. CARRY TAPE(黑色)前部分与尾部分各留出150~300mm长度不装产品
2. 每穴放置1PCS产品, 放置方式如图所示
3. 包装机包好后, 在REEL的个等分点上贴胶带, 以防止REEL张开, 每REEL贴1PCS标签
4. 包装数量: 750PCS/REEL, 17REEL/CARTON, 12750PCS/CARTON
5. 依次将产品放入箱内, 共放17盘(图一)
6. 封箱, 在封好的纸箱上按客户要求写上料号, 数量等(图二)
7. 顺向出料, 单孔朝外。

GENERAL TOLERANCE		DWG NO.	LZA0521-002	APPD:	WIND	Scale	1:1
X.±0.45	x.±5°	Title	BATTERY 3P 2.54PITCH 6.2H 包装图	CHKD:		UNIT	mm
.X±0.35	.x'±2°			DR:			
.XX±0.25	.xx'±1°	Part NO.		Date	2012/04/13		
.XXX±0.15	.xxx'±0.5°						
SHEET	1/1	东莞市汉硕电子科技有限公司					