

REV.	ECN.NO.	MODIFY.CONTENT	DATE
A		NEW	2011/10/31

PICK AND PLACE  
AREA DIA 3.5

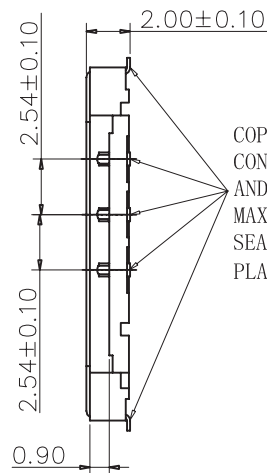

COPLANARITY OF  
CONTACT FEET  
AND CLIP FEET  
MAX 0.10mm TO  
SEATING  
PLANE (PCB)

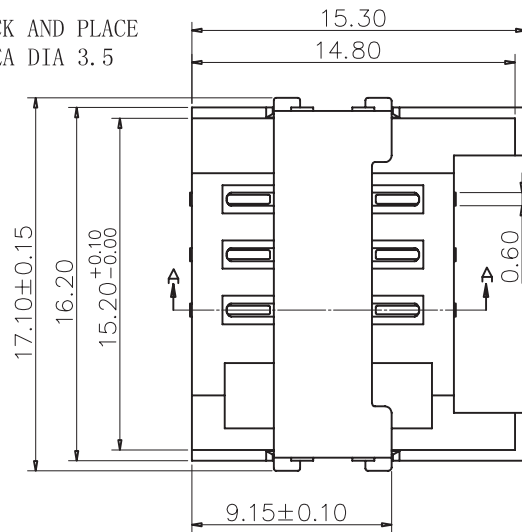
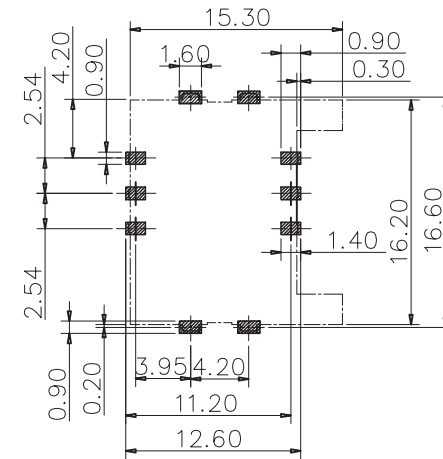

RECOMMENDED PCB LAYOUT  
TOL: ( $\pm 0.05$ )

NOTES:

- MATERIAL:  
I/M: HIGH TEMPERATURE THERMOPLASTIC+COPPER ALLOY  
HOOK: COPPER ALLOY
- MECHANICAL PERFORMANCE  
CONTACT NORMAL FORCE: 20-50 gf PET PIN AT WORKING POSITION  
(HEIGHT=0.15)  
LIFE: 1,500 CYCLES MIN.
- ELECTRICAL PERFORMANCE  
CONTACT RESISTANCE<PER CONTACT>: 100m MAX  
INSULATION RESISTANCE: 100V DC, 1000M  
CURRENT RATING : 1.0A.  
DIELECTRIC WITHSTANDING VOLTAGE: 500V AC MAX.  
VOLTAGE RATING<SELV>: 15V DC MAX.
- OPERATING TEMPERATURE RANGE: -25°C TO +85°C.
- STORAGE TEMPERATURE RANGE: -25°C TO +60°C.

PART NUMBER INFORMATION :

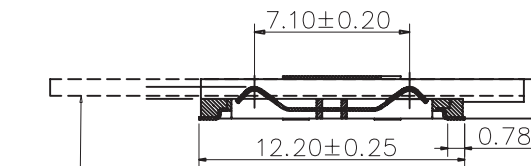
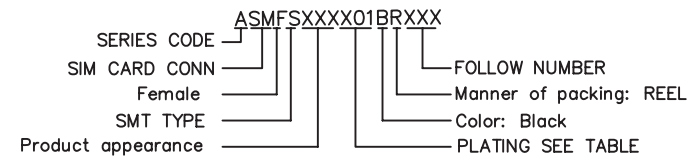

LOCKING AND  
CODING OF THE  
CARD CONTROLLED  
BY CUSTOMER

SECTION A-A

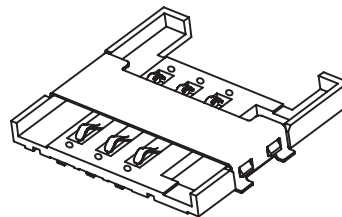

GENERAL TOLERANCE		DWG NO.	LZA0512-001	APPD:	WIND	Scale	1:1
X $\pm 0.45$	x. $\pm 5^{\circ}$	Title	SIM CARD 6P 2.0H	CHKD:		UNIT	mm
.X $\pm 0.35$	.x $\pm 2^{\circ}$			DR:			
.XX $\pm 0.25$	.xx $\pm 1^{\circ}$	Part NO.	ASMFS200A01BR013	Date	2012/02/29		
.XXX $\pm 0.15$	.xxx $\pm 0.5^{\circ}$						
SHEET	1/1	东莞市汉硕电子科技有限公司					

REV.	ECN.NO.	MODIFY.CONTENT	DATE
A		NEW	2012/04/13

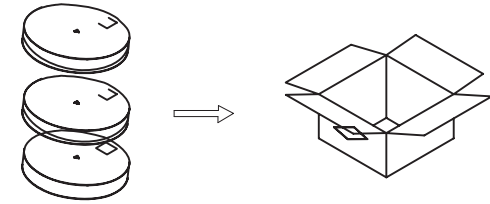
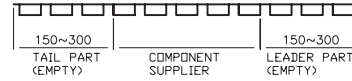
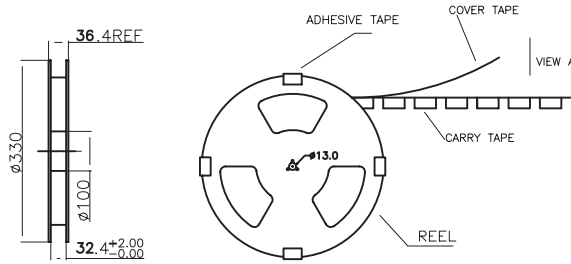

每箱装8盘, 依次叠在一起(图一)

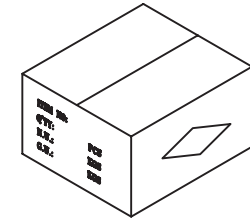

封箱, 填写相关内容(图二)

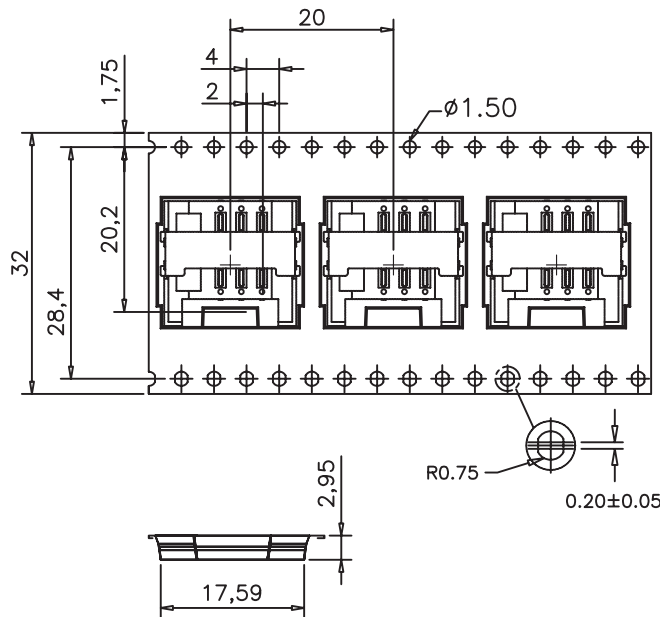

NOTE:

1. CARRY TAPE(黑色)前部分与尾部分各留出150~300mm长度不装产品
2. 每穴放置1PCS产品, 放置方式如图所示
3. 包装机包好后, 在REEL的个等分点上贴胶布, 以防止REEL张开, 每REEL贴1PCS标签
4. 包装数量: 1000PCS/REEL, 8REEL/CARTON, 8000PCS/CARTON
5. 依次将产品放入箱内, 共放8盘(图示一)
6. 封箱, 在封好的纸箱上按客户要求写上料号, 数量等(图示二)

GENERAL TOLERANCE		DWG NO.	LZA0521-008	APPD:	WIND	Scale	1:1
X.±0.45	x.*±5°	Title	SIM CARD 6P 2.0H 外焊 包装图	CHKD:		UNIT	mm
.X±0.35	.x.*±2°			DR:			
.XX±0.25	.xx.*±1°	Part NO.		Date	2012/04/13		
.XXX±0.15	.xxx.*±0.5°						
SHEET	1/1	东莞市汉硕电子科技有限公司					