

REV.	ECN.NO.	MODIFY.CONTENT	DATE
A		NEW	2011/10/31

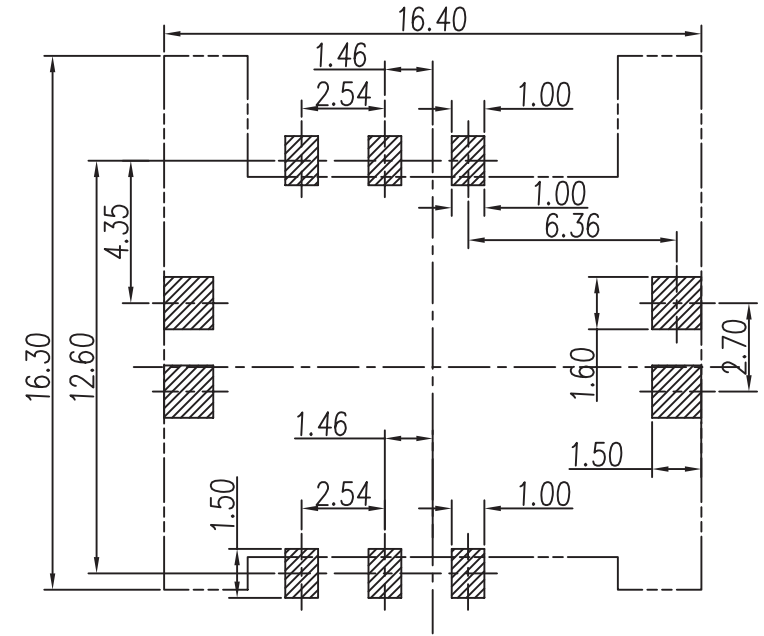
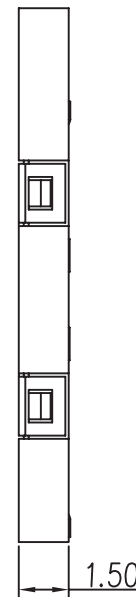
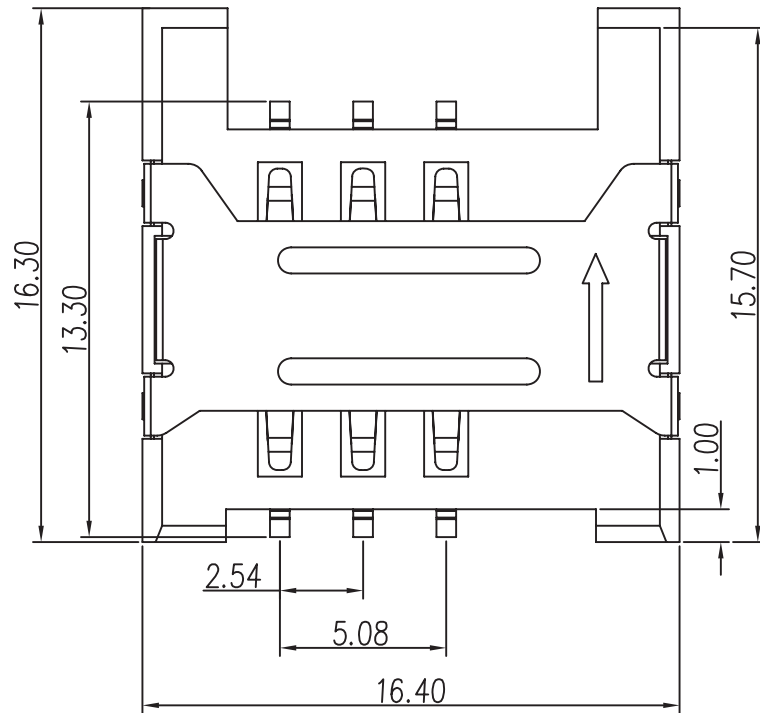

Recommended PCB Layout

Specification

\*Electrical Characteristics:

Contact Current Rating: 0.5 Amperes.  
 Dielectric Withstanding Voltage: AC500V r.m.s.  
 Insulation Resistance: 500 MΩ Minimum.  
 Contact Resistance: 30 mΩ Maximum.

PART NUMBER INFORMATION :

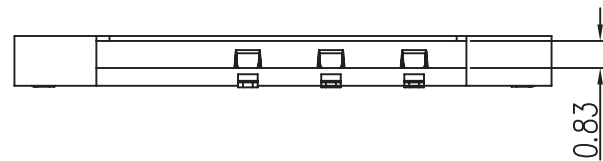
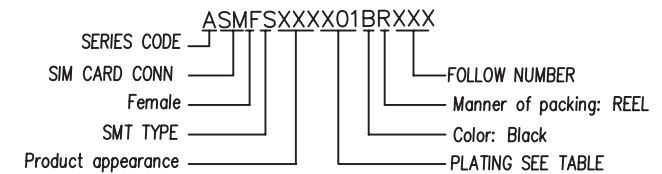

GENERAL TOLERANCE		DWG NO.	LZA0512-002	APPD:	WIND	Scale	1: 1
X.±0.45	x.±5°	Title	SIM CARD 6P 1.5H 有档(连板式)	CHKD:		UNIT	mm
.X±0.35	.x'±2°			DR:			
.XX±0.25	.xx'±1°	Part NO.	ASMFS150A01BR011	Date	2012/02/29		
.XXX±0.15	.xxx'±0.5°						
SHEET	1/1	东莞市汉硕电子科技有限公司					

REV.	ECN.NO.	MODIFY.CONTENT	DATE
A		NEW	2012/04/13

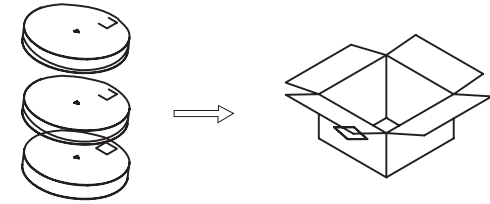
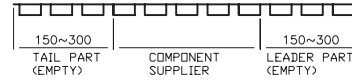
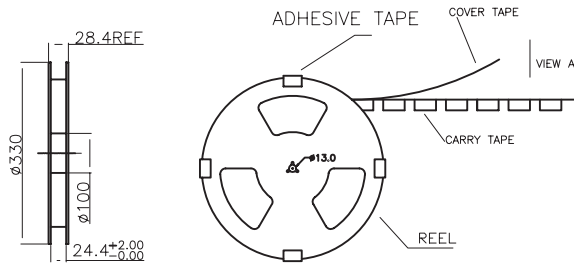

每箱装12盘, 依次叠在一起(图一)

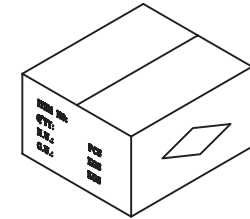

封箱, 填写相关内容(图二)

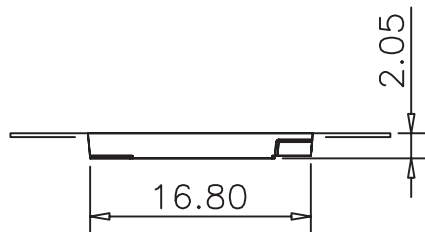
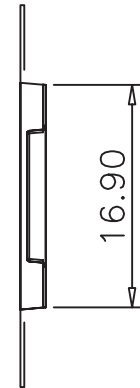
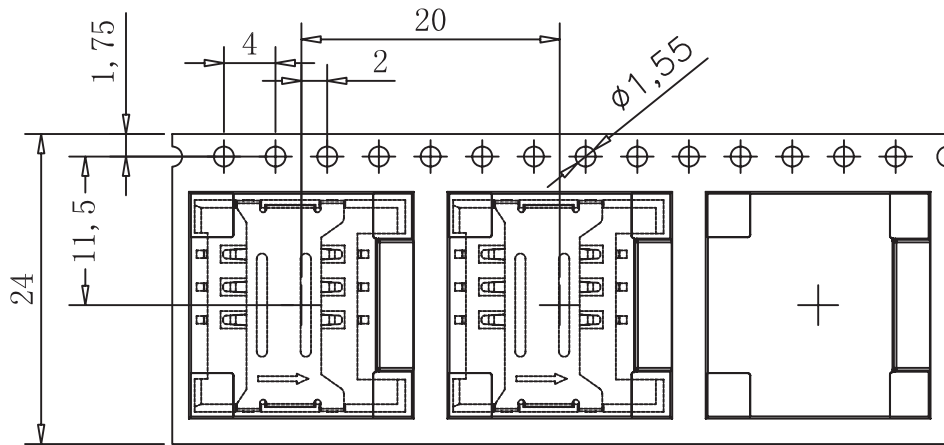

NOTE:

1. CARRY TAPE(黑色) 前部分与尾部分各留出150~300mm长度不装产品
2. 每穴放置1PCS产品, 放置方式如图所示
3. 包装机包好后, 在REEL的个等分点上贴胶带, 以防止REEL张开, 每REEL贴1PCS标签
4. 包装数量: 1500PCS/REEL, 12REEL/CARTON, 18000PCS/CARTON
5. 依次将产品放入箱内, 共放12盘(图一)
6. 封箱, 在封好的纸箱上按客户要求写上料号, 数量等(图二)

GENERAL TOLERANCE		DWG NO.	LZA0521-001	APPD:	WIND	Scale	1:1
X.±0.45	x.*±5°	Title	SIM CARD 6P 1.5H 内焊 有档 包装图	CHKD:		UNIT	mm
.X±0.35	.x.*±2°			DR:			
.XX±0.25	.xx.*±1°	Part NO.		Date	2012/04/13		
.XXX±0.15	.xxx.*±0.5°						
SHEET	1/1	东莞市汉硕电子科技有限公司					