

REV	DESCRIPTION	DATE

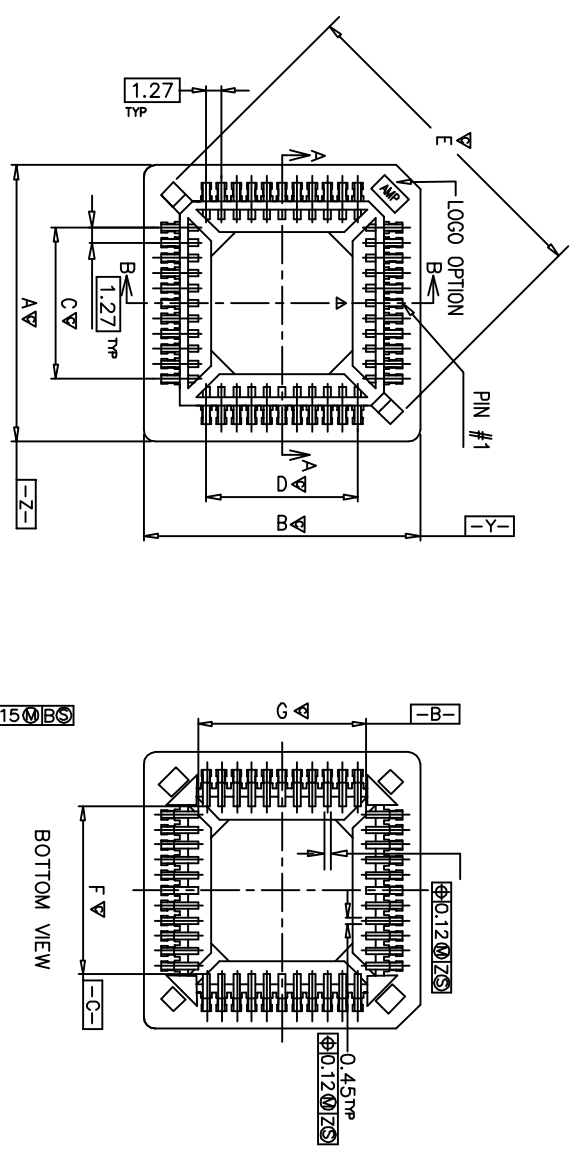

“∇” CRITICAL DIMENSION.

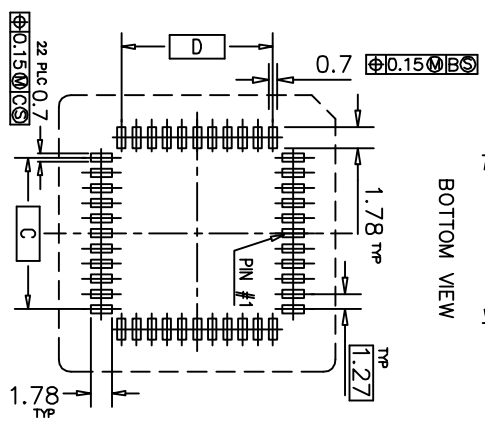
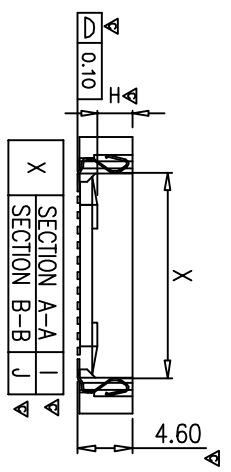

NO. OF POSITIONS	A	B	C	D	E	F	G	H	I	J
84	35.90	35.90	25.40	25.40	45.20	26.80	26.80	2.90	29.69	29.69
68	30.82	30.82	20.32	20.32	37.98	21.72	21.72	2.90	24.61	24.61
52	25.74	25.74	15.24	15.24	30.78	16.64	16.64	2.75	19.53	19.53
44	23.20	23.20	12.70	12.70	27.20	14.1	14.1	2.90	16.99	16.99
32	18.12	20.66	7.62	10.16	21.89	9.16	11.60	2.6	11.90	14.45
28	18.12	18.12	7.62	7.62	20.00	6.70	6.70	2.75	11.90	11.90
20	15.58	15.58	5.08	5.08	16.38	4.16	4.16	2.75	9.36	9.36

TOLERANCE	MATERIAL	UNITS	SCALE	DATE	
X ±0.25	X'	± 2"	mm	1 / 1	20110922
.XX ±0.15	.XX'	± 1"	CHECKED	PROL.	
XXX ±0.10			DRAWN		

东莞市汉硕电子科技有限公司

DRAWN NAME:	DWG NO.
PLCC SMT 成品 (AMP)	JK0080628L13

MATERIAL: HOUSING: PPS+30% GF UL94 V-0, BROWN.
 CONTACT: PHOSPHOR BRONZE.
 FINISH:
 CONTACT: 100 u" MIN SN ONLY PLATED ON SOLDERING
 END OVER 50 u" MIN. NICKEL UNDER-PLATING.

SPECIFICATION:
 CURRENT RATING: 1 A.
 VOLTAGE RATING: 250 V.
 DIELECTRIC STRENGTH: 600V FOR 1 MINUTE.
 CONTACT RESISTANCE: 20 mΩ MAX.
 INSULATOR RESISTANCE: 1000MΩ MIN. AT 500V DC.
 SOLDERING TEMPERATURE: 260°C.
 TEMPERATURE: -55°C ~ +105°C
 DURABILITY: 25 CYCLES.

ORDER INFORMATION:
 141 XX - X X B Z 0 0 X X
 no of contact 20P~84P
 Contact Plated:
 A-Tin/Non-Lead
 B-Full Gold (Non Lead)
 C-Tin/Non-Lead (Sn Only Non Shine)
 Contact Material/Type:
 0-Phos. bronze/A-Type
 1-Phos. bronze/S-Type
 Insulator Material:
 B-PPS

Logo: N-No Logo
 A-AMP
 Packaging:
 1-Tube
 2-Tape Reel
 Post : 0-Without
 Insulator Color:
 7-Brown