

REV	DESCRIPTION	DATE
1	SEE ECN EN930701	2004/07/01

MATERIALS:

Contacts: Brass.
 Insulator: PBT UL 94V-0 Rated.
 Shell: Cold Roller Steel.

FINISHES:

Contact: Gold Flash.
 Shell: Nickel Plated.

ORDER INFORMATION:

391 18 - 1 A X 0 0 X 1 N

- Series No. _____
- No. of contact: _____
- Contact Plated: _____
- 1-Selective Gold
- Contact Type: _____
- A-MALE/MALE
- Contact pitch / _____
- Boardlock option: _____
- 0-19.00mm/Dual Rows
- 2-19.00mm/Upper Row
- 4-19.00mm/Lower Row
- Logo: N-No Logo
- 1-芬登
- Option: _____
- 0-With rivet, with screw assembled
- 1-With rivet, with screw unassembled
- 2-With rivet,w/o screw
- Shell plated: _____
- 0-Nickel plated
- Insulator Color: _____
- 0-Black

ELECTRICAL CHARACTERISTICS:

Contact Current Rating: 1 Amperes.
 Dielectric Withstanding Voltage: AC 1000V r.m.s.
 Insulation Resistance: 5000 Megohms Minimum. at DC 500V.
 Contact Resistance: 25 Milliohms Maximum.
 Operating Temperature: -55°C to +105°C.

MECHANICAL CHARACTERISTICS:

Contact Insertion Force: 341 g. Maximum.
 Contact Separation Force: 21 g. Minimum.

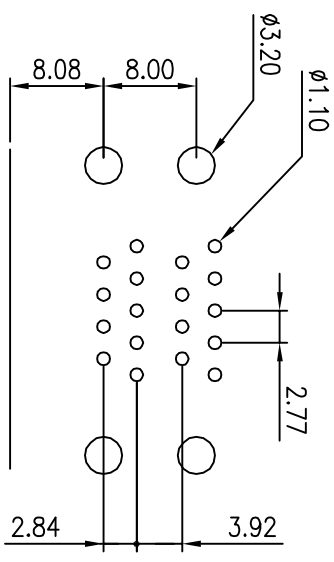
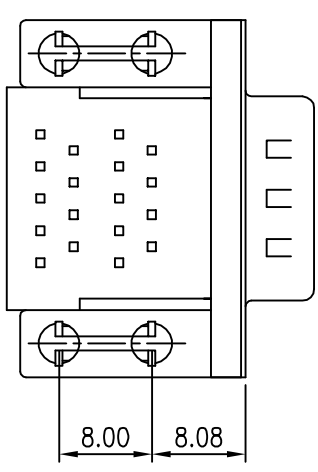
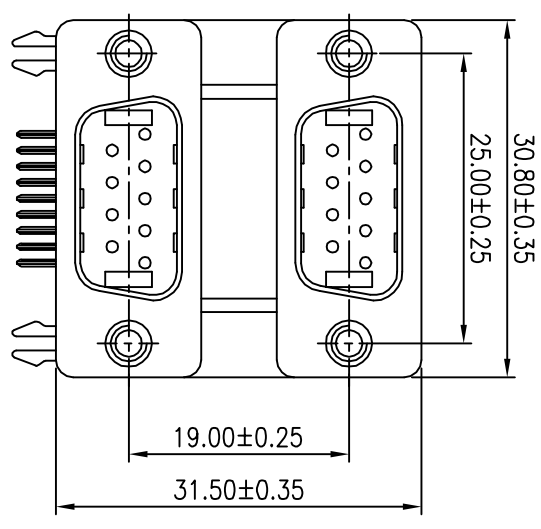

RECOMMENDED PCB LAYOUT

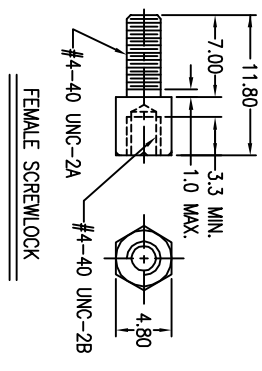
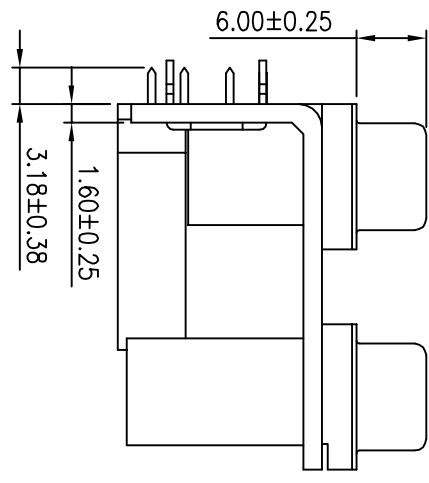

TOLERANCE	MATERIAL	UNITS	SCALE	DATE
X ±0.25	X'	± 2'	mm	1 / 1
XX ±0.15	X'X'	± 1'	CHECKED	PROL.
XXX ±0.10			yangbin	yangbin

DATE: 20110922
 东莞市汉硕电子科技有限公司

DRAWN NAME:	DWG NO.
D-SUB 2 IN 1 9P MALE/9P MALE	JK0080628L4